

# CONGRESSIONAL CEMETERY

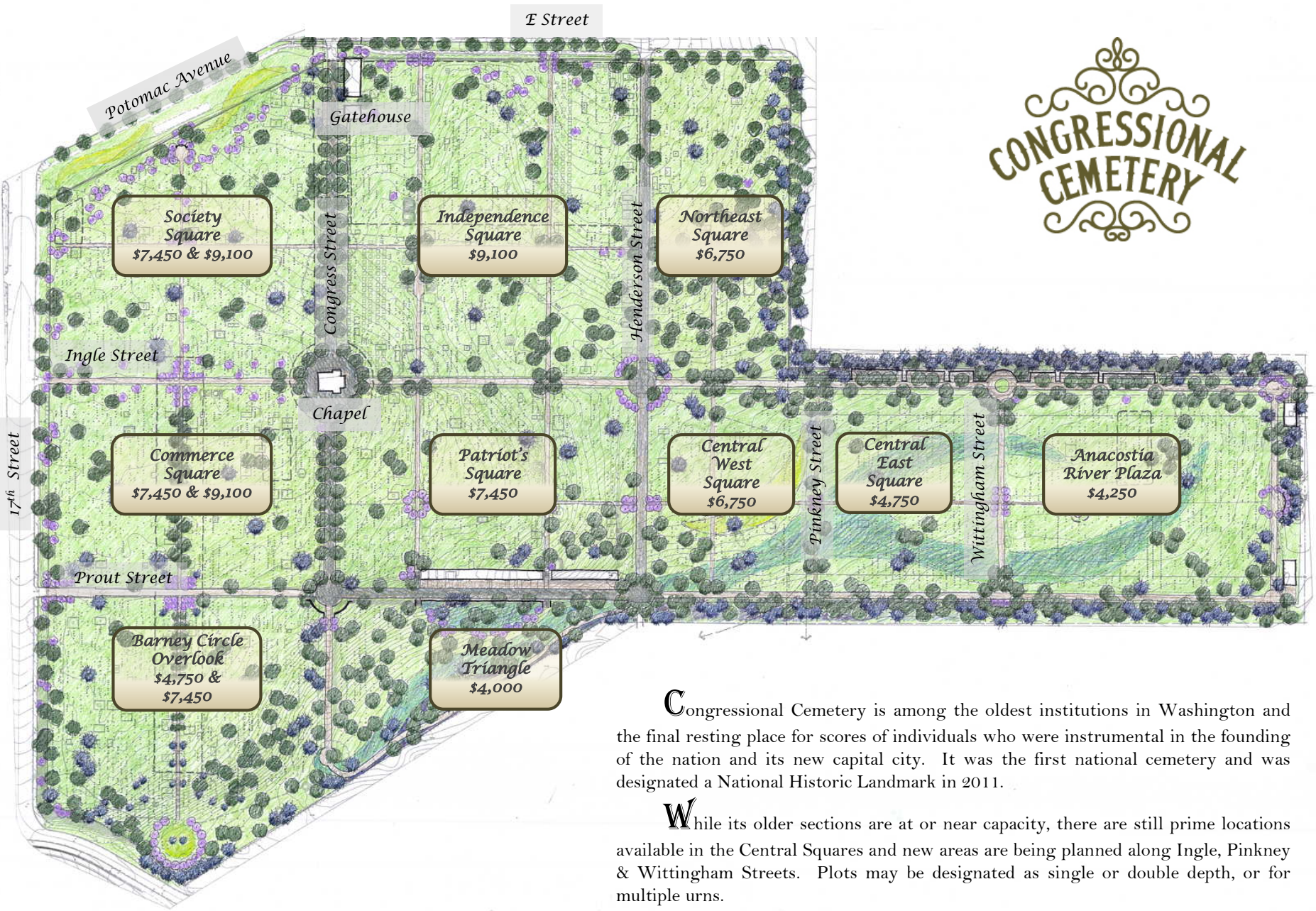

Congressional Cemetery is among the oldest institutions in Washington and the final resting place for scores of individuals who were instrumental in the founding of the nation and its new capital city. It was the first national cemetery and was designated a National Historic Landmark in 2011.

While its older sections are at or near capacity, there are still prime locations available in the Central Squares and new areas are being planned along Ingle, Pinkney & Wittingham Streets. Plots may be designated as single or double depth, or for multiple urns.